

REVISION HISTORY			
REV	DESCRIPTION	DATE	APPROVED
C	DCN 49214	07/19	STW

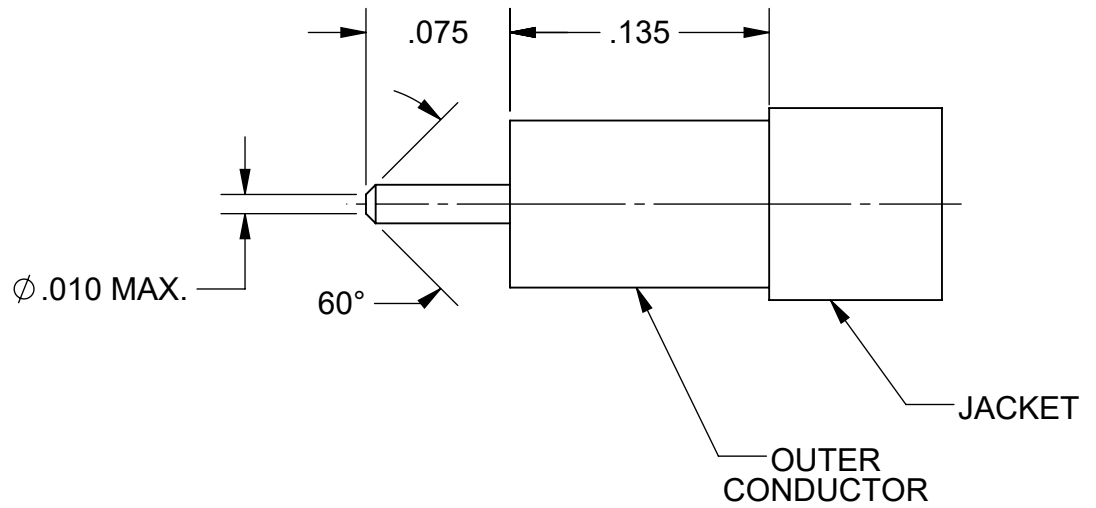

STEP 1:
TRIM CABLE JACKET AND CABLE DIELECTRIC AS SHOWN. DO NOT NICK INNER CONDUCTOR. POINT CABLE INNER CONDUCTOR.

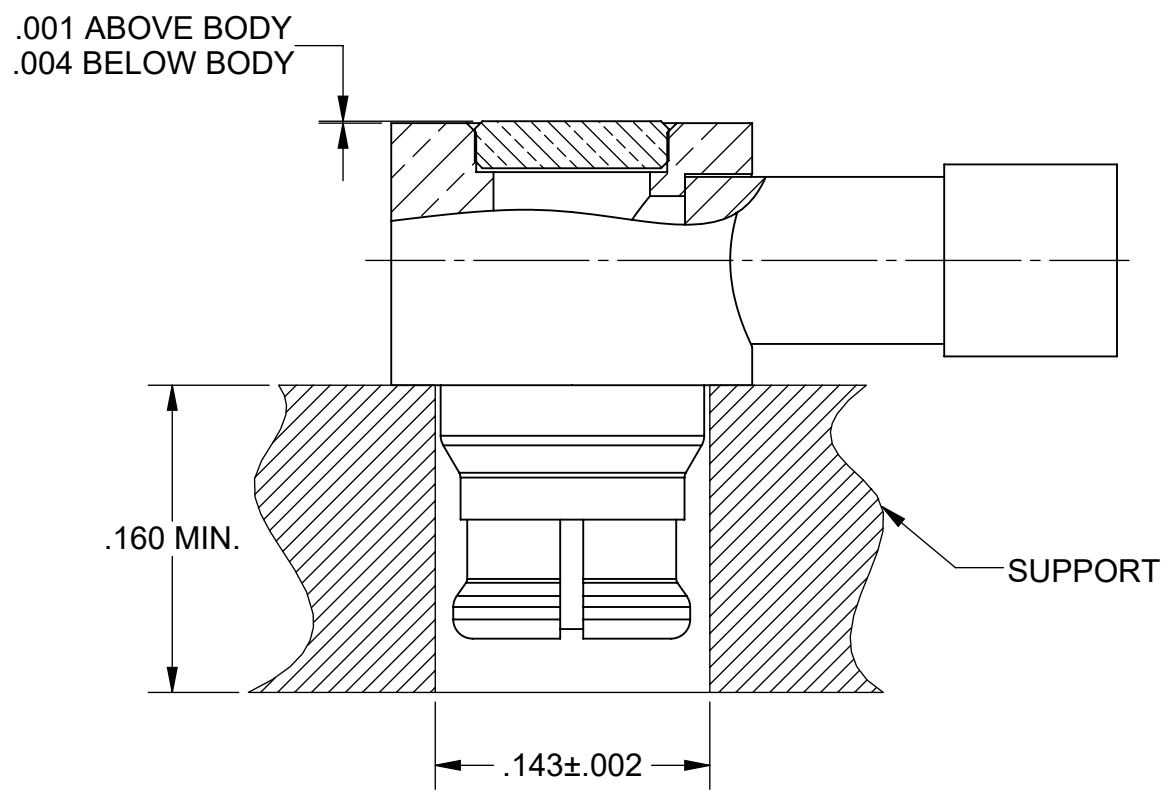

STEP 3:
INSTALL PRESS CAP TOWARD CONNECTOR AND GENTLY PRESS UNTIL SEATED +.001/-.004.

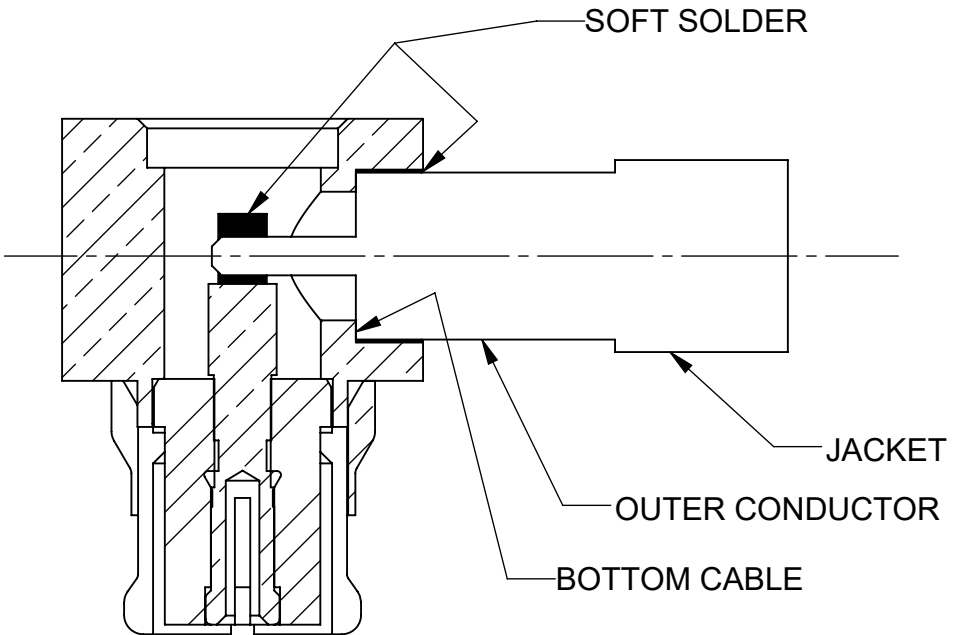

STEP 2:
CHECK ORIENTATION OF CENTER CONTACT SLOT (ADJUST IF REQUIRED) FROM THE BOTTOM & REAR OF CONDUCTOR. SOFT SOLDER CONTACT TO INNER CONDUCTOR AND CABLE OUTER CONDUCTOR TO BODY.

MATERIAL: N/A	DIMENSIONS ARE IN INCHES TOLERANCES:	UNLESS OTHERWISE SPECIFIED	 2400 Centrepark West Drive, Suite 100 West Palm Beach, FL 33409
FINISH: N/A	FRACTIONAL: ±1/64 ANGULAR: X° ±1°0' X'X' ±15'	1) ALL DIMENSIONS ARE AFTER PLATING. 2) BREAK CORNERS & EDGES .005 R. MAX. 3) CHAM. 1ST & LAST THREADS. 4) SURFACE ROUGHNESS 63 / MIL-STD-10. 5) DIA.'S ON COMMON CENTERS TO BE CONCENTRIC WITHIN .005 T.I.R. 6) REMOVE ALL BURRS	
SURFACE AREA: N/A	DECIMAL: X ±.030 .XX ±.010 .XXX ±.005	INTERPRET DIMENSIONS AND TOLERANCES PER ASME Y14.5M - 1994	TITLE: CABLE ASSEMBLY INSTRUCTIONS
1214-4002	PROPRIETARY	THIRD ANGLE PROJECTION	SIZE B CAGE CODE 95077 DWG. NO. 300-12-007
USED ON:	THE INFORMATION CONTAINED IN THIS DRAWING IS THE SOLE PROPERTY OF SV MICROWAVE, INC. ANY REPRODUCTION IN PART OR AS A WHOLE WITHOUT THE WRITTEN PERMISSION OF SV MICROWAVE, INC IS PROHIBITED.		SCALE: 10:1 SHEET 1 OF 1