

| REVISION HISTORY | | | |
|------------------|-------------|-------|----------|
| REV | DESCRIPTION | DATE | APPROVED |
| - | NRN 34581 | 01/08 | STW |
| | | | |

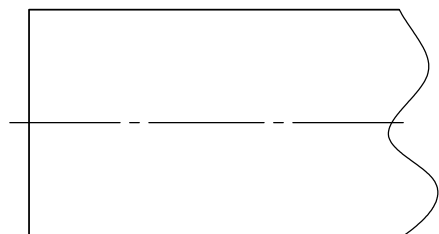

STEP 1

FLUSH CUT END OF CABLE BEFORE REMOVING THE FEP JACKET. DIP END OF THE CABLE INTO FLUX AND THEN INTO A SOLDER POT MAINTAINED AT 500 °F TO A DEPTH OF 3/8" FOR (6) SECONDS MAX.

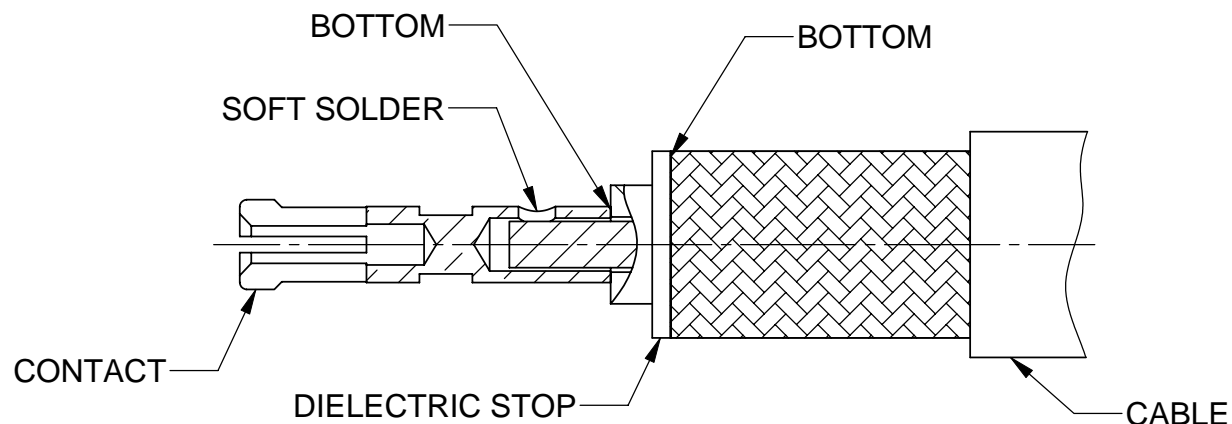

STEP 2

SOFT SOLDER CONTACT ON AS SHOWN.

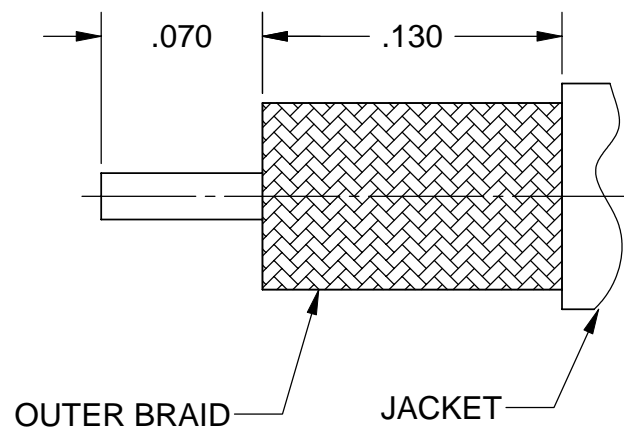

STEP 2

AFTER PRE TINNING TRIM TO DIMENSIONS SHOWN

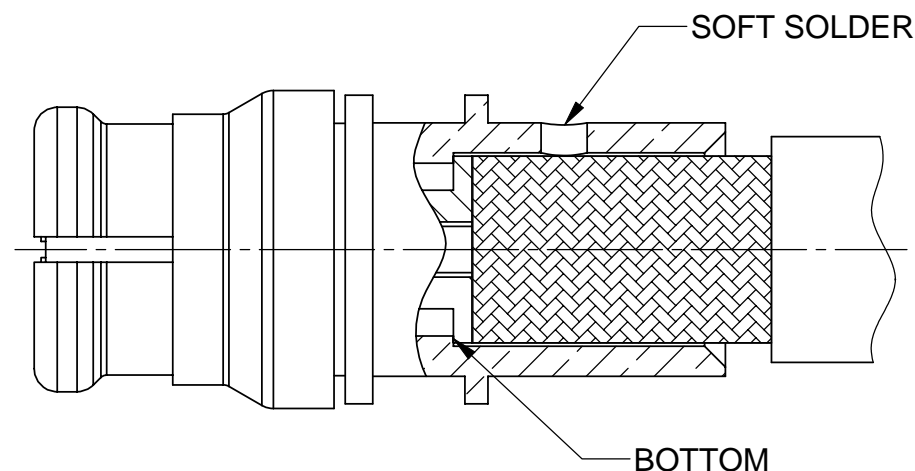

STEP 4

INSTALL CABLE INTO BODY AND SOFT SOLDER CABLE INTO BODY AS SHOWN

| | | | |
|--|--|--|---|
| MATERIAL: N/A | DIMENSIONS ARE IN INCHES TOLERANCES: FRACTIONAL: ±1/64 ANGULAR: X° ±1°0' X'X' ±15' | UNLESS OTHERWISE SPECIFIED 1) ALL DIMENSIONS ARE AFTER PLATING. 2) BREAK CORNERS & EDGES .005 R. MAX. 3) CHAM. 1ST & LAST THREADS. 4) SURFACE ROUGHNESS 63 √ MIL-STD-10. 5) DIA.'S ON COMMON CENTERS TO BE CONCENTRIC WITHIN .004 T.I.R. 6) REMOVE ALL BURRS | SV Microwave, Inc. 2400 Centrepark West Drive, Suite 100 West Palm Beach, FL 33409 |
| FINISH: N/A | DECIMAL: X ±.030 .XX ±.010 .XXX ±.005 | INTERPRET DIMENSIONS AND TOLERANCES PER ASME Y14.5M - 1994 | TITLE: CABLE ASSEMBLY INSTRUCTIONS |
| SURFACE AREA: N/A | THIRD ANGLE PROJECTION | DRAWN: HLP 01/31/08 CHECKED: STW 01/31/08 APPROVED: STW 01/31/08 E.M. SIMULATION: N/A | SIZE: B CAGE CODE: 95077 DWG. NO.: 300-12-019 |
| PROPRIETARY THE INFORMATION CONTAINED IN THIS DRAWING IS THE SOLE PROPERTY OF SV MICROWAVE, INC. ANY REPRODUCTION IN PART OR AS A WHOLE WITHOUT THE WRITTEN PERMISSION OF SV MICROWAVE, INC IS PROHIBITED. | | | SCALE: 16:1 SHEET 1 OF 1 |