

REVISION HISTORY			
REV	DESCRIPTION	DATE	APPROVED
-	NRN 33816	08/06	STW

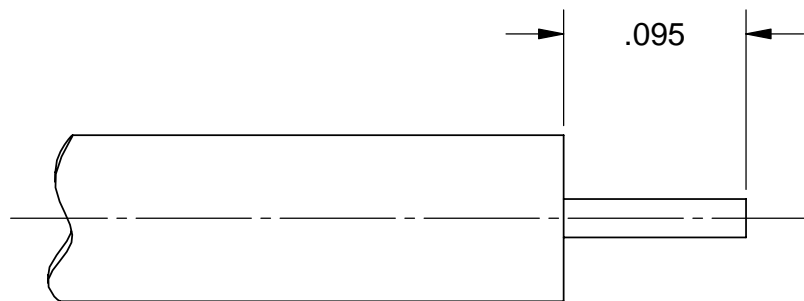

**STEP 1:**  
TRIM CABLE TO DIMENSIONS SHOWN.  
DO NOT NICK CENTER CONDUCTOR.  
REMOVE ALL BURRS.

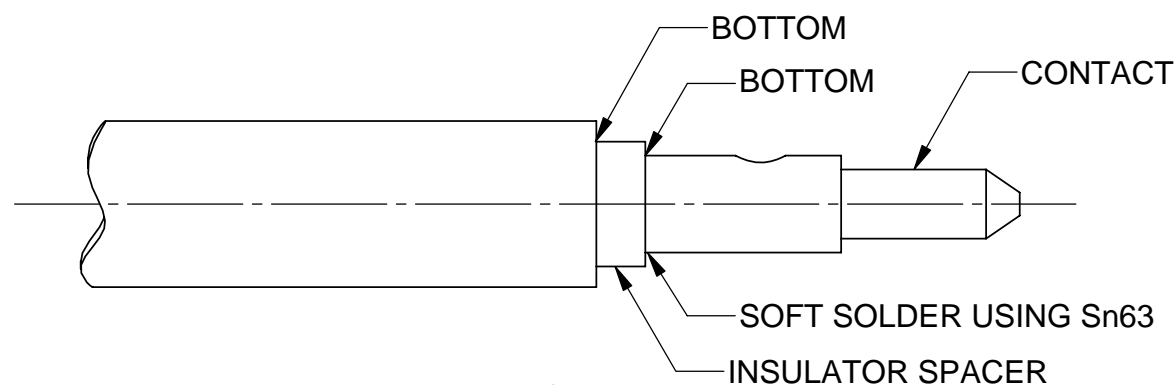

**STEP 2:**  
SLIDE CONTACT OVER CENTER CONDUCTOR AND BOTTOM AGAINST INSULATOR SPACER. SOFT SOLDER CONTACT TO CENTER CONDUCTOR USING Sn63 SOLDER. REMOVE EXCESS SOLDER AS NECESSARY.

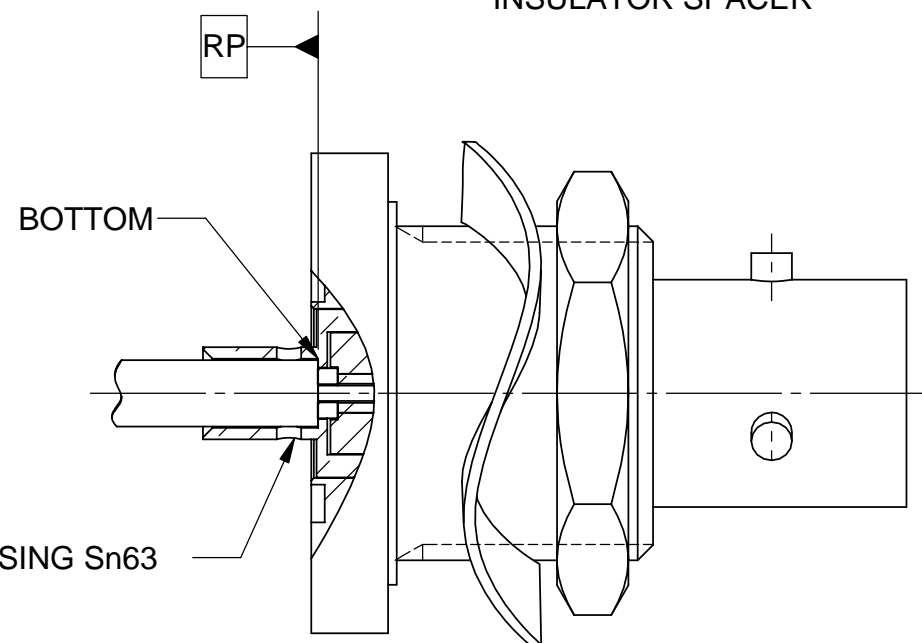

**STEP 3:**  
INSERT CABLE INTO REAR OF CONNECTOR AND BOTTOM AGAINST CABLE REFERENCE PLANE. SOFT SOLDER CABLE JACKET TO CONNECTOR BODY USING Sn63 SOLDER. REMOVE EXCESS SOLDER AS NECESSARY.

SOFT SOLDER USING Sn63

ITAR NOTICE  
THIS DOCUMENT CONTAINS DATA THAT IS CONTROLLED BY INTERNATIONAL TRAFFIC IN ARMS REGULATIONS. THIS DATA CANNOT BE EXPORTED, DISCLOSED OR TRANSFERRED TO FOREIGN BUSINESS OR PERSONS (INCLUDING EMPLOYEES, CONSULTANTS OR AGENTS).

SF8721-6000  
USED ON:

MATERIAL:	PER BOM
FINISH:	PER BOM
SURFACE AREA:	N/A
	<b>PROPRIETARY</b>
THE INFORMATION CONTAINED IN THIS DRAWING IS THE SOLE PROPERTY OF SV MICROWAVE, INC. ANY REPRODUCTION IN PART OR AS A WHOLE WITHOUT THE WRITTEN PERMISSION OF SV MICROWAVE, INC IS PROHIBITED.	

DIMENSIONS ARE IN INCHES TOLERANCES:	
FRACTIONAL:	±1/64 ANGULAR: X° ±1°0' X'X' ±15'
DECIMAL:	.X ±.030 .XX ±.010 .XXX ±.005
INTERPRET DIMENSIONS AND TOLERANCES PER ASME Y14.5M - 1994	
<b>THIRD ANGLE PROJECTION</b>	

UNLESS OTHERWISE SPECIFIED	
1) ALL DIMENSIONS ARE AFTER PLATING. 2) BREAK CORNERS & EDGES .005 R. MAX. 3) CHAM. 1ST & LAST THREADS. 4) SURFACE ROUGHNESS 63 √ MIL-STD-10. 5) DIA.'S ON COMMON CENTERS TO BE CONCENTRIC WITHIN .005 T.I.R. 6) REMOVE ALL BURRS	
DRAWN:	MEB 08/22/06
CHECKED:	STW 08/22/06
APPROVED:	STW 08/22/06
E.M. SIMULATION:	N/A

<b>SV Microwave, Inc.</b> 2400 Centrepark West Drive, Suite 100 West Palm Beach, FL 33409		
TITLE: <b>CABLE ASSEMBLY INSTRUCTIONS</b>		
SIZE <b>B</b>	CAGE CODE <b>95077</b>	DWG. NO. <b>300-87-021</b>
SCALE: 2:1		SHEET 1 OF 1