

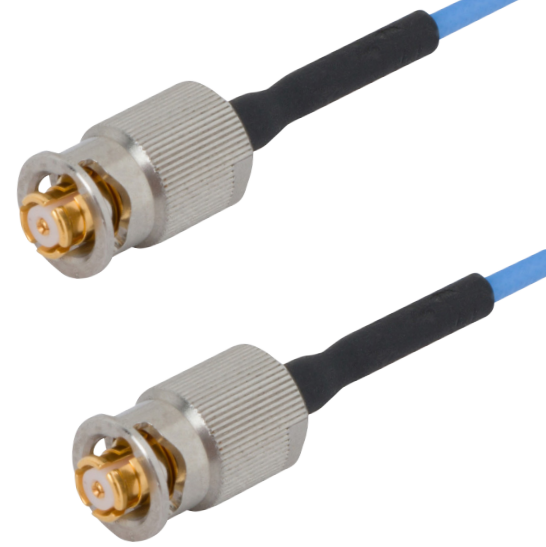

Secure-Locking Interconnects



Features & Benefits

- Quarter turn bayonet locking feature on standard SMP/SMPM interface
- Eliminates damage to PCB solder joints
- Low insertion/withdrawal force
- DC - 40GHz (SMP), 65GHz (SMPM)

Applications

- Bench-top testing
- High vibration environments
- Applications with a high number of mating cycles
- Mil/Aero

Quick-Turn, Secure-Locking RF Connectors

Amphenol SV Microwave has developed a complete suite of spring-loaded RF interconnects featuring a bayonet-style coupling nut for quick, easy, and secure connections. This product line solves a problem typically associated with standard SMP and SMPM RF interfaces-- namely, that the classic push-on design may come loose in high-vibration and shock environments common to military and space applications.

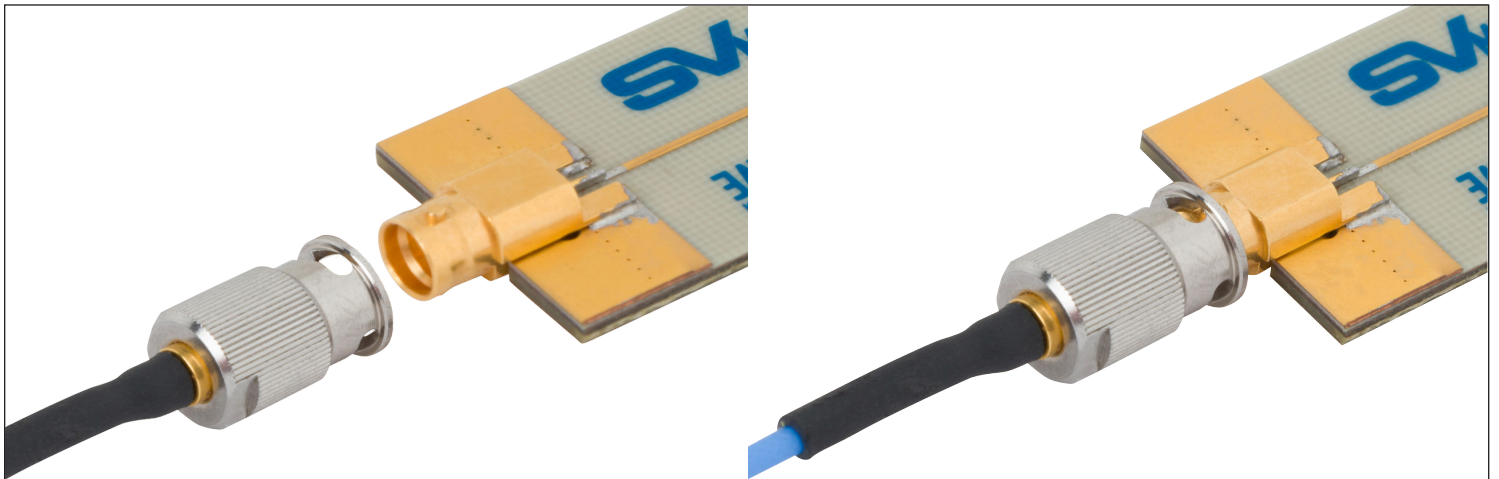

Figure 1: An SMP Female QB Cable Assembly (7012-1300) is shown with an SMP Male PCB QB Edge Launch Connector, SB in both the unmated and mated positions.

QuarterBack™ Product Line Characteristics

While the addition of the bayonet-style coupling nut detracts from the small factor of the SMP and SMPM interface, it still remains high-density. Below is a list of product specifications and sizes, useful when planning a system design.

Specifications		
Electrical	SMP	SMPM
Impedance	50Ω	50Ω
Frequency Range	40 GHz	65 GHz
VSWR	1.15:1 to 26.5 GHz typ.	1.10:1 to 26.5 GHz typ.
	1.5:1 to 40 GHz typ.	1.30:1 to 50 GHz typ.
Mechanical	SMP	SMPM
Mating Cycles (min)	1000	500
Temperature Rating	-65 to +165°C	-65 to +165°C

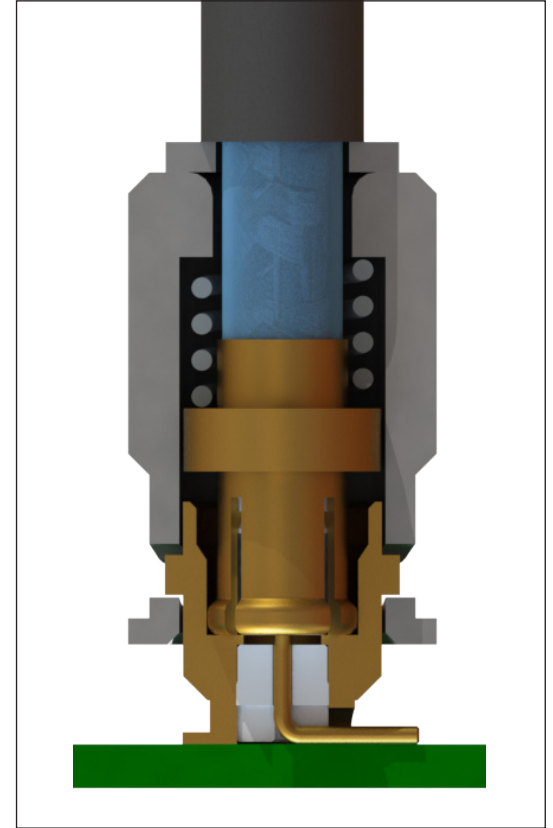

Figure 2: A cross-section of a mated QB pair showing the spring loaded action that makes this product line quick to mate.

SMP Style Connectors	
P/N: 1221-4 0049 SMP Female QB Cable Connector for .085 Cable	
P/N: 1221-40051 SMP Female QB Connector for .047 Cable	
P/N: 1211-66195 SMP Male QB Edge Launch Connector	
P/N: 1211-40032 SMP Male QB Surface Mount Connector	

SMPM Style Connectors	
P/N: 3221-60004 SMPM Female QB Connector for .085 Cable	
P/N: 3221-60003 SMPM Female QB Connector for .047 Cable	
P/N: 3211-60118 SMPM Male QB Edge Launch Connector, SB	
P/N: 3211-60112 SMPM Male QB Surface Mount Connector, R/A	

QuarterBack™ Product Line

P/N	Description
1112-6114	SMP Male QB to SMA Male Adapter
1211-40032	SMP Male PCB QB Surface Mount Connector
1211-66195	SMP Male PCB QB Edge Launch Connector, SB
1221-40049	SMP Female QB Connector for .085 Cable
1221-40050	SMP Female QB Connector for .141 Cable
1221-40051	SMP Female QB Connector for .047 Cable
1222-60007	SMP Female QB Connector, R/A for .047 Cable
1222-60008	SMP Female QB Connector, R/A for .085 Cable
3211-60112	SMPM Male PCB QB Surface Mount Connector, R/A
3211-60118	SMPM Male PCB QB Edge Launch Connector, SB
3221-60003	SMPM Female QB Connector for .047 Cable
3221-60004	SMPM Female QB Connector for .085 Cable
3222-60003	SMPM Female QB Connector, R/A for .047 Cable
3222-60004	SMPM Female QB Connector, R/A for .085 Cable
7012-1084	SMP Female QB to SMA Male 12" Cable Assembly for .085 Cable
7012-1085	SMP Female QB to SMA Male 6" Cable Assembly for .085 Cable
7012-1086	SMP Male QB Bulkhead to SMA Male 6" Cable Assembly for .085 Cable
7012-1087	SMP Male QB Bulkhead to SMA Male 12" Cable Assembly for .085 Cable
7012-1300	SMP Female QB to SMA Male 24" Cable Assembly for .085 Cable
7012-1301	SMP Female QB to SMA Male 6" Cable Assembly for .047 Cable
7012-1302	SMP Female QB to SMA Male 12" Cable Assembly for .047 Cable
7012-1303	SMP Female QB to SMA Male 24" Cable Assembly for .047 Cable
7032-8544	SMPM Female QB to SMA Male 12" Cable Assembly for .085 Cable
7032-8545	SMPM Female QB to SMA Male 6" Cable Assembly for .085 Cable
7032-8547	SMPM Female QB to SMA Male 12" Cable Assembly for .047 Cable
7032-8548	SMPM Female QB to SMA Male 6" Cable Assembly for .047 Cable
7032-9468	SMPM Male QB Bulkhead to SMA Male 6" Cable Assembly for .047 Cable
7032-9469	SMPM Male QB Bulkhead to SMA Male 12" Cable Assembly for .047 Cable
SF1112-6144	2.92mm Female to SMP Male QB Adapter
SF1132-6078	2.92mm Female to SMPM Male QB Adapter
SF1211-66214	SMP Male QB Solderless PCB Compression Mount Connector, 2 Hole (Stripline)
SF1211-66214-1S	SMP Male QB Solderless PCB Compression Mount Connector, 2 Hole, with 4.76mm Screws (Stripline)
SF1211-66214-2S	SMP Male QB Solderless PCB Compression Mount Connector, 2 Hole, with 6.35mm Screws (Stripline)